

Apt 16, Vue Epec
3 Bed Property For Sale in St. Peter Port

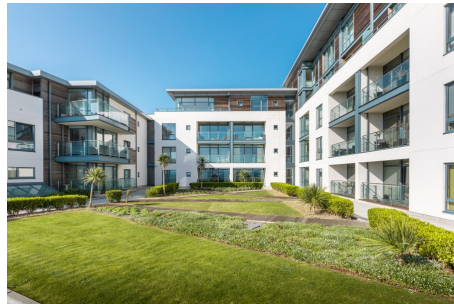

Description

This luxury penthouse apartment is situated in the prestigious Vega development close to Admiral Park. In excellent order throughout and based on one level, it offers stunning, panoramic, South-facing views over Belle Greve Bay towards the Islands and over St. Peter Port. The apartment is accessed via a communal hallway and also has direct lift access including to the underground garage which has parking for two vehicles. The accommodation comprises entrance hall with storage and utility cupboard, three double bedrooms (one master with en-suite shower room and built-in wardrobes) family bathroom and superb, open plan kitchen/dining/sitting room which enjoys the aforesaid views and also has access to surrounding balcony which receives all day...

Property Reference: lvr_1146 - #10685

Price: Under Offer

Beds	3
Baths	2
Location	St. Peter Port, Guernsey
Availability	Local
Type	Property

Contact Livingroom

Livingroom House, North Clifton, St. Peter Port

<https://www.livingroom.gg>

