

Le Mont du Ouaisne

1 Bed Property For Sale in St. Brelade

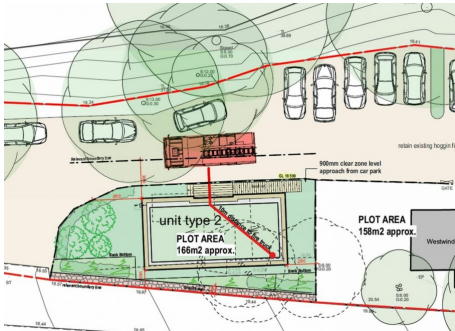

Description

Build your own chalet style home just minutes from the beach at Ouaisne Beach and in a coastal national park. This is a truly unique opportunity to build your own home with planning permission in place to build a one bedroom property which also benefits from one parking space and garden area. The site also benefits from mains water, electricity and drains. The plots are located on Ollivier Farm on Le Mont de Ousaine

Property Reference: mai_2712201 - #4049

Price: Under Offer

Beds	1
Baths	1
Location	St. Brelade, Jersey
Type	Property

Contact Maillard & Co.

Maillard & co.

31-33 New Street, St Helier

<https://maillardandco.com>

